

NOTES

1. ALL CONSTRUCTION DETAILS TO BE TO LOCAL AUTHORITY SPECIFICATION AND SATISFACTION.
2. EXISTING ROADS, EXISTING DRAINS OR PROPOSED DRAINS etc HAVE NOT BEEN COMPILED FROM "AS CON" SURVEYS (U.O.N.) & ARE INCLUDED FOR INFORMATION ONLY.
3. DRAINAGE PIPES TO BE RCP CLASS 2 (U.O.N.) STORMWATER DRAINAGE PIPE.
4. ALL GULLIES TO BE TRAPPED.
5. LEVELS ARE TO TOP OF BITUMEN AND ARE AT KERB FACE.
6. BLEND NEW PAVING AND KERBING SMOOTHLY TO EXIST.
7. MAX. BATTER SLOPES TO BE 1 IN 6.
8. ALL DISTURBED AREAS TO BE STABILISED TO THE SATISFACTION OF THE SUPERINTENDENT.
9. CLEARED VEGETATION SHALL NOT BE BURNT ON SITE.

LEGEND

- SEWER LINE
- EXISTING DRAINAGE PIPE & PIT
- PROPOSED DRAINAGE PIPE AND PIT
- FUTURE DRAINAGE PIPE & PIT
- UPSTREAM INVERT
PIPE DIAMETER/GRADE
DISTANCE BETWEEN STRUCTURES
DOWNSTREAM INVERT
- PROPOSED STREET SIGN AND POST
- GRATED INLET PIT (GP)
- SIDE ENTRY PIT (SEP)
- JUNCTION PIT (JP)
- PIT TYPE, NUMBER AND CHAINAGE
- RED LATERITE ASPHALT
REFER TO SPEC. FOR DETAILS
- BRICK PAVED SURFACE
REFER TO SPEC. FOR DETAILS
- EXISTING KERB
- FUTURE KERB
- SEMI-MOUNTABLE KERB
- MOUNTABLE KERB
- BARRIER KERB
- FLUSH KERB/BOND BEAM

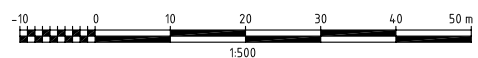
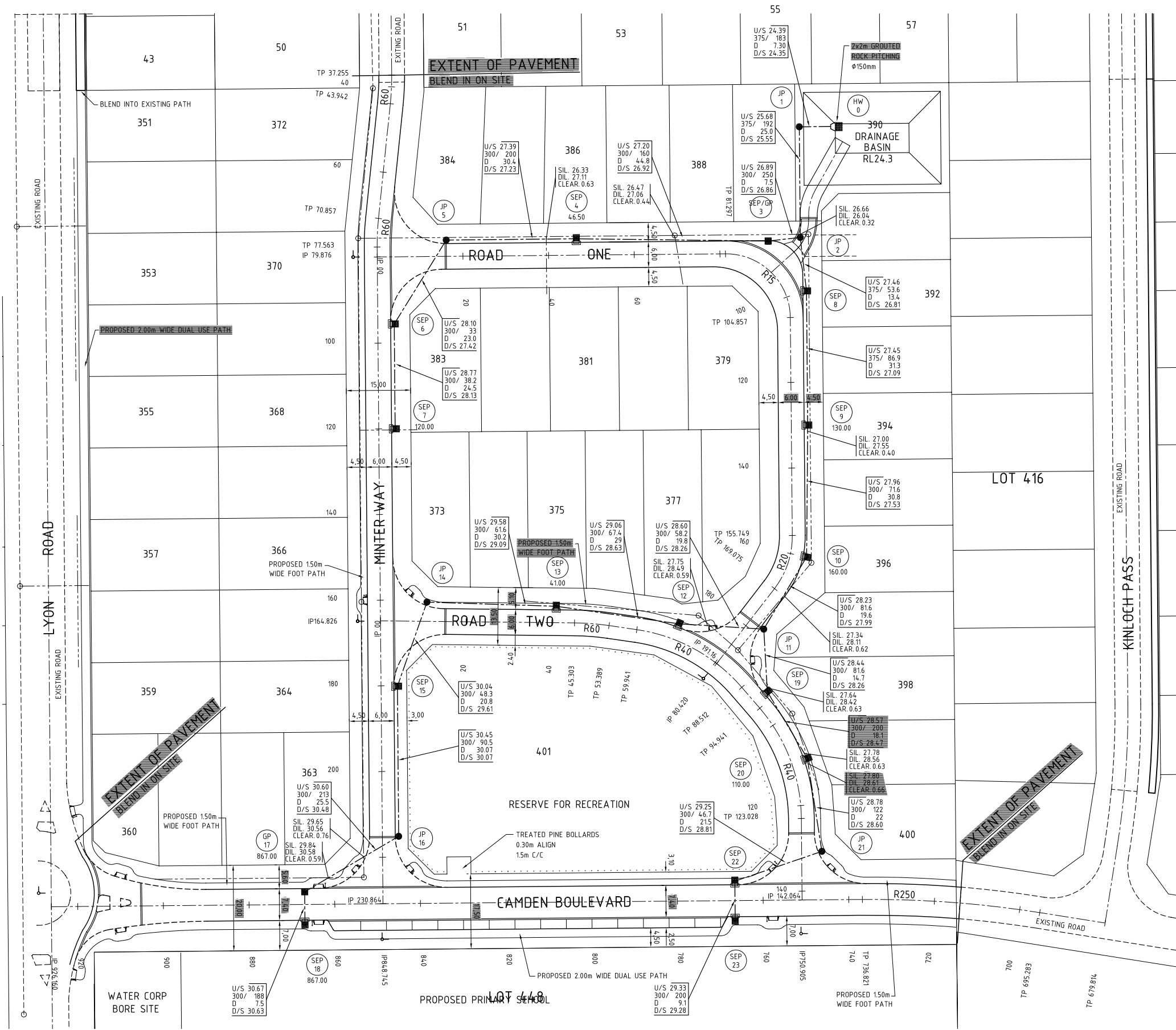

ROADWORKS & DRAINAGE PLAN
1:500

ALL DRAINAGE PITS TO BE TRAPPED WITH SOAKAGE AS PER CITY OF COCKBURN STANDARDS

EXISTING SERVICES - INFORMATION ON THESE DRAWINGS PURPORTING TO RELATE TO EXISTING SERVICES IS INDICATIVE ONLY AND MAY NOT BE COMPLETE REFER TO SPECIFICATION AND CLAUSE 12 OF AS4000

REV	REVISION	DATE	APPROVED
1	PATHS ADDED, GP17, SEP18 & ROAD TWO PRECAL AMENDED		
0	SEP/GP 3 CHANGED TO COMBINED GULLY/SEP & BASIN DEEPENED, NOTE ADDED	29/11/06	B.G.
B	DRAINAGE BASIN DETAILS AMENDED. DRAINAGE LINES AMENDED HW0 TO SEP9	07/11/06	B.G.
A	ISSUED FOR APPROVAL	25/10/06	L.M.

CLIENT
MILUC INVESTMENTS PTY LTD

THE CIVIL GROUP
CONSULTING CIVIL ENGINEERS
38 Richardson Street West Perth WA 6005
Telephone: (08) 9481 4255
Facsimile: (08) 9481 3900
Copyright The Civil Group WA Pty Ltd

DRAWN L. Fisher
DESIGNED L. Fisher
CHECKED B. Griffiths
APPROVED P. Golder
DATE 29th Nov 06

TITLE
**LOT 446 LYON ROAD
AUBIN GROVE
ROADWORKS & DRAINAGE PLAN**

WAPC No 126771

ORIGINAL SHEET SIZE	SCALE 1:500
A1 DO NOT SCALE	LEVEL DATUM : AHD
	SHEET 1 OF 1
DRAWING No	REV
7359-03	1